

Art Show Various Display Layouts

Each space is 12' x 6'

1 table, 2 chairs, 1 floor 4'Wx5'H

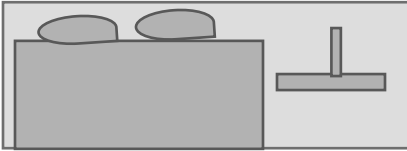

Wood Easel that holds 3 shelves

Browse Box, 6' table, floor 4'Wx5'H easel, chair



12' x 6' x 6' Floor Wall Display inside only + Chair

Displays on outside end walls only if on the space is at the end of the aisle
no displays on back of wall – guests cannot walk behind displays

Easels that can fit within 12'x 6' space
Depending on sizes of easels.

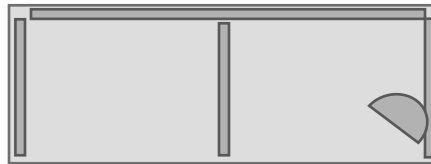
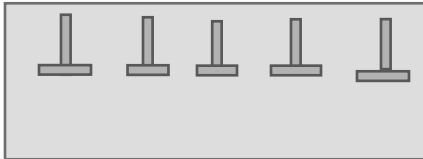

2-6' tables with 2 chairs

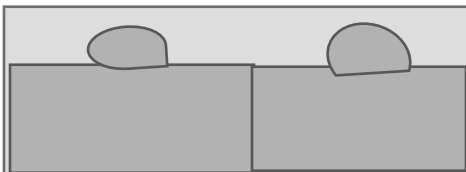

12' x 6' x 6' Floor Wall Display inside only + Chair

Displays on outside end walls only if on the space is at the end of the aisle-
no displays on back – guests cannot walk behind displays

